

Friday, February 13, 2009

Fallen Oak Cir, TN
Sevier County, TN parcel# 0350 C 018.00

Property Report

Location

| | |
|-------------------------|----------------------|
| Property Address | Fallen Oak Cir TN |
| Subdivision | Boon Docks |
| County | Sevier County, TN |

Current Owner

| | |
|------------------------|---|
| Name | Meza Roberto & Edel Mira |
| Mailing Address | 2963 Sw 141St Ter Davie, FL 33330-4676 |

Property Summary

| | |
|--------------------------|-------------|
| Property Type | Residential |
| Land Use | |
| Improvement Type | |
| Total Square Feet | |

General Parcel Information

| | |
|----------------------------|---------------|
| Parcel/Tax ID | 0350 C 018.00 |
| Special Int | 000 |
| Alternate Parcel ID | |
| Land Map | 0350 |
| District/Ward | 09 |
| Census Tract/Block | |

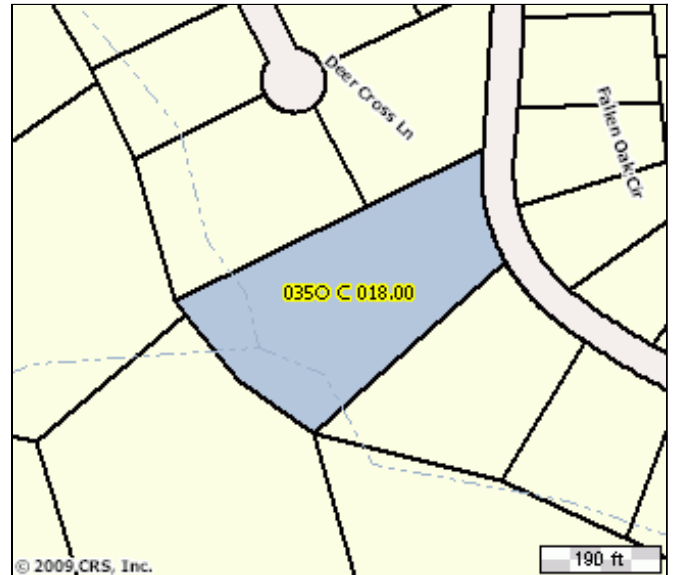

Sales History through 02/06/2009

| Date | Amount | Buyer/Owners | Buyer/Owners 2 | Instrument | Quality | Book/Page or Document# |
|------------|----------|--------------------------|----------------|----------------------------|----------------------|------------------------|
| 01/27/2006 | \$48,000 | Meza Roberto & Edel Mira | | | | 2452/66 |
| 11/29/1994 | \$20,000 | | | Accepted Waranty Deed Sale | Completely Qualified | 533/717 |
| 11/05/1982 | | Hall Beulah | | | | 315/667 |
| 09/13/1977 | | | | | | 271/ |

Tax Assessment

| Appraisals | Amount | Taxes | Amount | Jurisdiction | Rate |
|-------------------------------|----------|----------------------|----------|--------------|------|
| Tax Year | 2008 | City Taxes | \$0 | | |
| Appraised Land | \$39,300 | County Taxes | \$151.31 | Sevier | 1.54 |
| Appraised Improvements | \$0 | Total Taxes | \$151.31 | | |
| Total Tax Appraisal | \$39,300 | Exempt Amount | | | |
| Total Assessment | \$9,825 | Exempt Reason | | | |

Mortgage History

| Date | Loan Amount | Borrower | Lender | Book/Page or Document# |
|----------|-------------|----------------------------------|-----------------|------------------------|
| 1/6/2006 | \$30,000 | Meza Roberto Edel Mira Isabel | Bb&T Collateral | 2452/68 |

Property Characteristics: Building

No Buildings were found for this parcel.

Property Characteristics: Extra Features

No extra features were found for this parcel.

Property Characteristics: Lot

| | |
|--------------------|------------------------|
| Land Use | |
| Lot Dimensions | |
| Acreage | 2.44 |
| Block/Lot | /68 |
| Latitude/Longitude | 35.887824°/-83.714066° |

Property Characteristics: Utilities/Area

| | | | |
|-----------------|---------|---------------------------|-----------|
| Gas Source | Private | Road Type | Paved |
| Electric Source | Public | Topography | Rolling |
| Water Source | Public | District Trend | Improving |
| Sewer Source | Public | Special School District 1 | 0 |
| Zoning Code | | Special School District 2 | 0 |
| Owner Type | Private | | |

Legal Description

| | | | |
|-------------|------------|----------------|-------|
| Subdivision | Boon Docks | Plat Book/Page | 23 /8 |
| Block/Lot | /68 | Description: | |